



Office of the Monroe County Surveyor
Trohn Enright-Randolph

Health Services Building
119 West 7th Street
Bloomington, IN 47404
Phone: (812) 349-2570

Dear User,

The following images were obtained in 2017 by the Office of the Monroe County Surveyor from the State Imaging and Microfilm Laboratory at the Indiana State Archives. The field notes and plats for Lawrence County are stored on microfilm Reel 1903 at the Indiana State Archives. Each page provided by the State Imaging and Microfilm Laboratory is approximately 18MB. Our office combined the pages by Township & Range and reduced the resulting pdfs. This process may have caused some degradation in quality. We will provide unreduced images of specific pages if required. Please contact us at 812-349-2570 or at SurveyorsOffice@co.monroe.in.us to request a higher quality image of any specific page.

The pdfs are bookmarked with the original page numbers as assigned by the State Imaging and Microfilm Laboratory.

Be prepared to provide the county name, reel number, and the required page numbers when requesting full sized images.

If you would like a DVD of an entire county, please provide us with one DVD per county along with a self-addressed, stamped envelope.

Trohn Enright-Randolph
Monroe County Surveyor

T 4 N

R 2 W



Township N^o IV North Range N^o II west of the 2nd Meridian.

Surveyed by Arthur Henrie. 1881

Description of the Soil on the interior Sectional lines.



Township N^o IV North Range N^o II West of the 2ⁿ^d Meridian.

Surveyed by Arthur Henrie. 181

Description of the Soil on the interior Sectional lines.

Meanders of the Right Bank
of White River in
T4N-R2W.

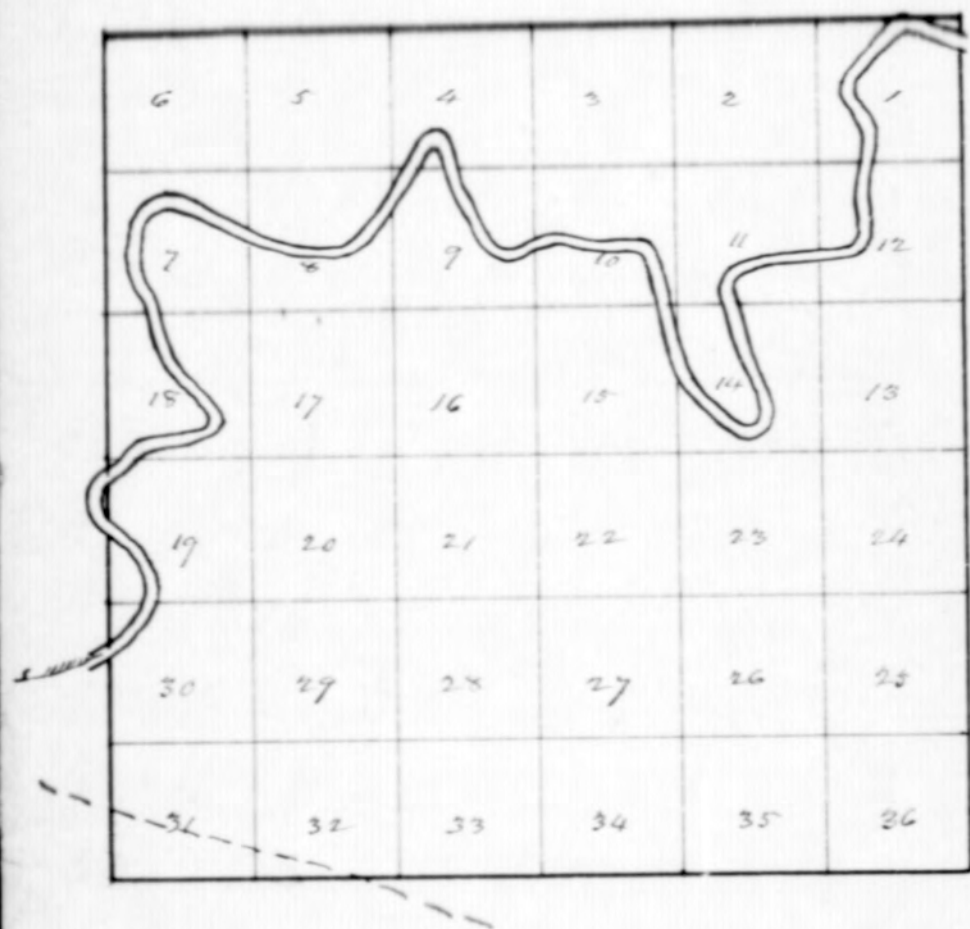

Comp. with the original.

Meander of the East Fork of
White River from post in the N.
boundary of T4. N. R2 W. up right bank

N70 E	11.00	in Sec. 30, T4. N. R2 W.
N64 E	7.00	
N50 E	7.50	
N35 E	5.47	to line betw. Sec. 19 & 30

N16 E	6.50	in Sec. 19, T4. N. R2 W.
N13 W	5.00	
N32 W	16.75	
N40 W	14.50	
N47 W	5.50	
N46 W	10.55	to post on Range line

From post in Range line N. side 19.
N. side of bend.

N60 E	25.50	
-------	-------	--

T4 N. R2 W

Meander Continued

N85 E	16.75	
N87 E	10.00	
N81 E	5.75	
N49 E	7.50	
N29 E	10.50	
N15 W	5.00	
N44 W	30.00	
N36 W	8.00	a Spring
N36 W	13.50	
N40 W	9.50	
N39 W	5.00	to line betw. Sec. 7 & 18
N31 W	9.50	(a Spring) in Sec 7
N16 W	8.50	
N12 W	6.75	
N16 W	22.00	
N22 E	10.00	
N34 E	19.50	✓

T4 N. R2 W

Meander Continued

N55 E	13.60	
N77 E	6.50	
S60 E	10.50	
S57 E	9.50	
S61 E	6.50	a Brook 5 hrs. wide
S61 E	6.00	
S57 E	10.60	to line betw. Sec. 7 & 8
S60 E	19.00	in Sec. 8, T4 N. R2 W
S71 E	19.00	
S87 E	25.00	
N48 E	8.00	
N30 E	28.00	
N45 E	4.39	to line between Sec. 8 & 9
N25 E	7.00	in Sec 9
N28 E	16.50	line betw. Sec. 4 & 9

4th R2W

Meanders Continued

N28 E	3.80	in Sec. 4, 4th R2W
N49 E	9.00	
S60 E	12.50	
S32 E	4.62	line betw. Sec. 4 & 9
S34 E	19.00	in Sec. 9, 4th R2W
S24 E	12.70	
S35 E	6.00	a brook 30 lbs. wide
S35 E	4.00	
S45 E	5.00	
S75 E	8.00	
N88 E	14.20	line between Sec. 9 & 10
N86 E	17.50	in Sec. 10, 4th R2W
S86 E	14.00	
East	17.00	
S79 E	11.50	✓

4th R2W

Meanders Continued

S62 E	12.00	
S15 E	9.00	
S5 E	11.50	
S11 E	12.93	line betw. Sec. 10 & 15
S15 E	10.00	in 15, 4th R2W
S11 E	6.80	line betw. Sec. 14 & 15
S16 E	17.50	in Sec. 14, 4th R2W
S33 E	22.50	
S50 E	15.50	
S78 E	5.00	
N71 E	21.00	
N2W	5.50	
N21W	10.50	
N29W	19.50	
N24W	6.00	✓

L4 N R2 W Meandering Contint

N32 W 14.25
N25 W 6.70 line between Sec. 11 & 14

N16 W 16.00 in Sec. 11

N6 E 12.00

N63 E 8.50

N86 E 26.50

N89 E 15.00

N79 E 5.50 line betw. Sec. 11 & 12

East 13.00 in Sec 12, L4 N. R2 W

N80 E 8.50

N62 E 10.00

N7 E 8.00

N9 W 33.45 line between Sec. 11 & 12

N10 W 6.50 (a Spring) in Sec 1.
✓

L4 N R2 W

Meandering Continued

N10 W 23.50 in Sec 1.

North 12.00 Rocky very high

N9 E 12.25

N29 E 18.50

N68 E 21.50

N80 E 7.50 - N. boundy. of L4 N. R2 W

N83 E 8.00

N69 E 6.00

N61 E 8.23 to post in Right bank
on the Range line
between Range 1 & 2 W



T. A. 4. N. R. A. 271 272 777. Sea?

11 Ark. 20 in dia. beam 110 E. 6 lbs. ash, 10
Beak 20 " " " 155 E. 10 " "

East On the Line On the South Boundary of sea 32.
T. A. N. R. 271.

40,00 Set a trap for support at the arch on the line from
whitby, Beak 10 in dia. beam 127 N. 27 lbs. ash
& 11 Oak 20 " " " 154 N. 31 " "

80,00 Set a Log on 10 in dia. beam for the cor. of sea 32 & 33

East On the Line On the South Boundary of sea 33.
T. A. N. R. 271.

40,00 Set a trap support from which a (Line line)
Beak 28 in dia. beam 123 N. 43 lbs. ash, 10
Log on 124 " " " 117 N. 8

80,00 Set the trap post on the line from whitby
Log on 10 in dia. beam 157 E. 10 lbs. ash, 10
Be. 6 " " " 14 N. 10 " "

East On the Line On the South Boundary of sea 34
T. A. N. R. 271.

40,00 Set a trap support on the line from whitby
Beak 10 in dia. beam 122 N. 15 lbs. ash, 10
11 Oak 24 " " " 117 N. 22 " "

80,00 Set a post on the line for the cor. of sea 34 & 35
from whitby, Beak 10 in dia. beam 162 E. 37 lbs. ash,
and 10 " " " 16 N. 18 " "

East On the Line On the South Boundary of sea 35
T. A. N. R. 271.

40,00 Set the trap post support at the line from whitby
Beak 10 in dia. beam 150 E. 25 lbs. ash, 8
11 Oak 24 " " " 10 N. 20 " "

T. A. 4. N. R. A. 271 272 777. Sea?

80,00 Set the trap post support on the line from whitby
35 & 36. from whitby.
Log on 20 in dia. beam for the cor. of sea 35 & 36.

East On the Line On the South Boundary of sea 36.
T. A. N. R. 271.

40,00 Set the trap post support on the line from whitby
11 Oak 10 in dia. beam 176 E. 33 lbs. ash, 10
Log on 8 " " " 14 E. 14 " "

80,00 Set the cor. of T. A. N. R. 271. For S. boundary sea 31 & 32. See
end of Line ship

East Boundary.

North On the East Boundary of sea 36. T. A. N. R. 271

40,00 Set a trap support in a thicket on a very high hill
Not bearing line

80,00 Set a post for the cor. of sea 35 & 36. from whitby,
Beak 6 in dia. beam 165 N. 7 lbs. ash, 10
11 Oak 10 " " " 14 E. 14 " "
Ground very hilly & bushy. Timber (Oak, Hick) &
Log on.

North On the East Boundary of sea 35. T. A. N. R. 271.

3 1/2 Set a trap 10 in dia. in the line.

40,00 Set a trap support from whitby,
11 Oak 30 in dia. beam 136 E. 20 lbs. ash, 10
Beak. — " " " 188 N. 11 " "

80,00 Set a post for the cor. of sea 24 & 25. from whitby,
11 Oak 12 in dia. beam 124 N. 35 lbs. ash, 10
Log on 10 " " " 10 " "
Ground very bushy, good, farming land, timber
Oak, Sugar, Maple, 112 Spruce.

North On the East Boundary of sea 24. T. A. N. R. 271.

T. A. H. A. R. N. 272nd Min. Ind.

30.30 To a Sugar 14 in dia: in the line
 40.00 Set a post from which,
 Sugar 12 in dia: beam N 13 E 15 the dist: 13,
 Do 18 " " " S 42 W 44 " "
 51.30 Interest to Indian Boundary and set apart for the
 end of tract. Sec. 130 T. 4 N. R. 21 W. from which,
 Buck 18 in dia: beam S 35 W 9 the dist: 13,
 Do 17 " " " N 18 W 40 " "
 Lands middling for farming, Hilly, Timber, Oak,
 Buck, Sugar, &c. Surveyed by
 Dec. 25, 1864. J. W. Buntz, L.S.
 North On the East Boundary of sec. 24, T. 4 N. R. 21 W. Continues
 40.00 To the old post.
 66.50 To a Gum 12 in dia: in the line
 80.00 Set apart for the end of sec. 25 from which,
 Buck 10 in dia: beam S 37 W 13 the dist: 13,
 Do 12 " " " South 27 " "

North On the East Boundary of sec. 25, T. 4 N. R. 21 W.
 27.00 To a Buck 10 in dia: in the line, Corner N.
 40.00 Set a post from which,
 W Oak in dia: beam S 62 E 6 the dist: 13,
 Sugar 6 " " " N 15 E 9 " "
 58.00 Set apart on the Left Bank of White River for the end of
 sec. 25 from which,
 W Oak 10 in dia: beam S 51 W 12 the dist: 13,
 Sugar 10 " " " N 51 E 17 " "
 Land the same.
 North On the East Boundary of sec. 25, T. 4 N. R. 21 W. & 26
 63.86 To a W Oak 20 in dia: on the Right Bk of W. River
 for the end of sec. 25.
 80.00 Set apart for the end of sec. 24 from which,
 Buck 12 in dia: beam N 10 E 23 the dist: 13

T. A. H. A. R. N. 272nd Min. Ind.

To a corner 60 in dia: beam North 8 the dist: 13

North On the East Boundary of sec. 24, T. 4 N. R. 21 W.
 40.00 Set a post from which,
 Hogwood 6 in dia: beam N 17 E 6 the dist: 13,
 Buck 12 " " " East 5 " "
 44.00 Set apart on the Right Bank of White River for the end
 of sec. 24 from which,
 Sugar 8 in dia: beam N 67 W 17 the dist: 13,
 76.00 Set apart on the Right Bank of White River for the end
 of sec. 24 from which,
 Walnut 10 in dia: beam S 72 W 19 the dist: 13,
 Red Bud 6 " " " N 40 E 15 " "
 80.00 Set apart for the end of sec. 13724 from which,
 Buck 10 in dia: beam South 11 the dist: 13,
 Do 10 " " " N 15 E 13 " "
 Land rich Timber Buck, Sugar, Poplar, &c.

North On the East Boundary of sec. 13, T. 4 N. R. 21 W.
 33.45 To a Buck 20 in dia: in the line.
 40.00 Set a post from which,
 Buck 12 in dia: beam N 61 W 1 the dist: 13,
 Do 6 " " " " N 1 E 16 " "
 80.00 Set apart for the end of sec. 13713 from which,
 Sugar 10 in dia: beam S 27 W 39 the dist: 13,
 Buck 12 " " " N 12 W 30 " "
 Land hilly, Timber same as last mile.

North On the East Boundary of sec. 12, T. 4 N. R. 21 W.
 40.00 Set a post from which,
 W Oak 20 in dia: beam N 41 E 13 the dist: 13,
 Do 18 " " " " S 62 W 11 " "
 61.60 To a W Oak 20 in dia: in the line

8000 Set apart for the corp of sw. 1. 412 from which,
W Oak 5 in dia. bears S 31 E 6 1/2 the dist. to
the 6 1/2 " S 89 N 10 1/2 "
Sunde hilly, Timber Oak, Hick, some Poplar, 1 Bech,

North On the East Boundary of sw. 1. T. 4. N. R. 3 N.

5.50 To a Bech 18 in dia. in the line.

40.00 " " 10 " " Sunde for the cor of 74 to.

62.00 To a W Oak 12 " " in the line

*85.00 Set apart for the cor of T. 4 1/2 N. R. 2 1/2 N. from which,
Bech 10 in dia. bears S 70 E 13 the dist. to

Maple 10 " " S 88 E 31 " "

Sunde & timber same as last mile.

On account of Sully being missed

Surveyed by
Arthur Henry & Co.

Subdivisions

North Return Sw. 35 736 T. 4. N. R. 2 N.

1.10 To a W Oak 20 in dia. in the line.

28.50 " " Brook 10 in dia. red. clay. W.

40.00 Set apart for the corp of sw. 1. 412 from which,

W Oak 20 in dia. bears S 59 E 13 the dist. to

W Oak 20 " " S 46 E 13 " "

North Return Sw. 35 736 T. 4. N. R. 2 N.

27.00 To a Hick 20 in dia. in the line.

40.00 Set apart for the corp of sw. 1. 412 from which,

Bech 18 in dia. bears S 74 E 20 the dist. to

Poplar 8 " " S 54 N 26 " "

80.00 Set apart for the corp of sw. 25 26 35 736 from which,

W Oak 10 in dia. bears S 37 N 20 the dist. to

Bech 12 " " S 44 N 24 " "

Sunde hilly, Timber Oak, Hick, Bech &c.

East On a Random line between Sw. 25 736 T. 4. N. R. 2 N.

40.00 Set a tripit 7/8 supst.

80.00 Intersect the East Boundary 1/2 mile South of the post
cor of sw. 25 736. Sunde the same

West On the line between Sw. 25 736 T. 4. N. R. 2 N.

40.20 Set the tripit 7/8 supst. at the end of the line from
which, Bech 12 in dia. bears N 36 E 31 the dist. to

the 8 " " S 67 N 10 " "

80.00 To the post cor of sw. 25 26 35 736.

North Return Sw. 25 736 T. 4. N. R. 2 N.

7.50 To a W Oak 12 in dia. in the line.

40.00 Set a 7/8 supst from which,

W Oak 20 in dia. bears S 53 E 21 the dist. to

Hick 12 " " S 87 N 17 " "

80.00 Set apart for the cor of sw. 23 24 35 736 from which,
Sunde 12 in dia. bears S 67 E 16 the dist. to

the 10 " " S 18 E 8 " "

This mile is over very hilly land; some cliffs of rock

East On a Random line between Sw. 24 25 T. 4. N. R. 2 N.

40.00 Set a tripit 7/8 supst.

80.00 Intersect the N 73 line or East Boundary at the
post cor of sw. 24 25.

Sunde good for farming 1/2 of 1/2.

West On the line between Sw. 24 25 T. 4. N. R. 2 N.

40.00 Set a tripit 7/8 supst. at the end of the line from
which, Bech 12 in dia. bears N 72 N 13 the dist.
anda Hognon 6 " " S 34 E 20 " "

80.00 Set the post on of sec. 23, 24, 25 & 26.

North Between Sec 23 & 24 T. 4. N. R. 27.

7.25 To a Poplar 20 in dia. in the line

40.00 Set a post from which
W Oak 12 in dia. bears S 47 N 15 lbs dist. 20,
Maple 12 " " N 69 E 18 " "

47.10 To a W Oak 20 in dia. in the line.

80.00 Set a post for the cor of sec. 13, 14, 23 & 24 from
which, W Oak 24 in dia. bears N 26 E 38 lbs dist.
and a Loc 20 " " " N 45 E 43 " "

East On a Random line between Sec 13 & 24 T. 4. N. R. 27.

40.00 Set a temporary post.

80.10 Set a post the East Boundary 29 miles South of the
post cor of sec. 13 & 24
Land very good for farming W. Spruce.

West On the line between Sec 13 & 24 T. 4. N. R. 27.

40.05 Set the temporary post at the cor dish on the line from
which, Sugar 10 in dia. bears N 10 W 11 lbs dist.
and a Buck 10 " " " S 21 E 37 " "

80.10 Set the post cor. of sec. 13, 14, 23 & 24

North Between Sec 13 & 14 T. 4. N. R. 27.

11.25 To a Hickory 20 in dia. in the line.

40.00 Set a post from which
Buck 12 in dia. bears S 22 E 16 lbs dist. 20,
Sugar 18 " " " S 87 W 14 " "

54.00 To a Sugar 12 in dia. in the line.

80.00 Set a post for the cor of sec. 11, 12, 13 & 14 from
which, Buck 12 in dia. bears S 43 E 12 lbs dist.
To a Elm 10 " " " N 37 W 13 " "

Land the same.

East On a Random line between Sec 12 & 13 T. 4. N. R. 27.

40.00 Set a temporary post.

80.00 Set a post the N 13 line at East Boundary 30 miles South
of the post cor of sec. 12 & 13
Land best and rich; good for farming: W. Spruce

West On the line between Sec 12 & 13 T. 4. N. R. 27.

40.00 Set the temporary post at the cor dish on the line from
which, Elm 10 in dia. bears S 37 W 6 lbs dist.
and a Sugar 10 " " " N 42 W 16 " "

80.00 Set the post cor of sec. 11, 12, 13 & 14.

North Between Sec 11 & 12 T. 4. N. R. 27.

30.00 Set a post on the Left Bank of White River for the
cor of Grad. Sec 11 & 12 from which,
Red Bud 8 in dia. bears S 57 N 41 lbs dist. 20,
Land the same.

South Between Sec 11 & 12 T. 4. N. R. 27.

21.50 To a Hackberry 12 in dia. in the line.

36.00 To a Sand Barner E & W.

40.00 To a Sec. cor in the pond.

42.50 To the South side of pond

47.30 Set a post on the Right Bank of W. River for the
cor of sec. 11 & 12 from which,
Elm 10 in dia. bears S 76 W 18 lbs dist. 20,
Sugar 12 " " " S 60 E 15 " "
Land the same as last note.

East Between Sec 11 & 12 T. 4. N. R. 27.

25.76 Set a post on the Right Bank of the White River
for the cor of Grad. Sec. 11 & 12 from which,

I. A. 4. A. R. A. 2772nd Mm. Ind.

- East Sugar 8 in dia: bears S 23 E. 11 lbs dist; 70,
 80,00 Lc. 12 1/2 " " S 73 W. 10 " "
 Set a post for the ca of sec. 14, 15, 22 & 23 from which,
 Buck. 20 in dia: bears N 56 E. 7 lbs dist; 70,
 Lc. 1 1/2 " " S 48 E 1/2 " "
 Lands good for farming Timber Buck, Oak,
 Hickory &c. W. Spruce.
-
- East On a Random line between Sec. 14 & 23. I. A. A. R. 277
 40,00 Set a temporary post.
 80,00 Intersect the N 73 line 10 links North of the post
 ca of sec. 14, 13, 23 & 24. Lands the same.
-
- West On the line between Sec. 14 & 23. I. A. A. R. 277
 40,00 Set the temporary post at the ar dist on the line
 from which, N Walnut 10 in dia: bears. N 89 E 42 lbs dist;
 Buck. 12 " " " N 46 E 13 " "
 80,00 Set the post ca of sec. 14, 15, 22 & 23.
-
- North Between Sec. 14, 15. I. A. A. R. 277. 2nd Mm.
 40,00 Set a post for the ca of sec. 14, 15 from which,
 Sugar 8 in dia: bears N 44 W. 12 lbs dist; 70,
 Lc. 10 " " " N 31 E 13 " "
 This post stands on the cliffs of Rocks
 4282 Set the post on the Left Bank of N River for the ca.
 of frac. Sec. 14 & 15 from which,
 Elm 12 in dia: bears N 62 W. 8 lbs dist; 70,
 Sycamore 24 " " " N 82 E 10 " "
 Lands the same.
-
- South Between Sec. 14 & 15. I. A. A. R. 277.
 1632 Sugar 10 in dia: stands on the Right Bank of N.R.
 for the ca of frac. Sec. 14 & 15.

I. A. 4. A. R. A. 2772nd Mm. Ind.

- East Between Sec. 11 & 14. I. A. A. R. 277.
 2834 Set a post for the ca of sec. 11 & 14 on the Right Bank of N River.
 7021 Return Sec. 11 & 14. I. A. A. R. 277.
 40,00 Set a post for the ca of sec. 11 & 14 from which,
 Sugar 12 in dia: bears N 44 E. 12 lbs dist; 70,
 Buck. 10 " " " N 89 W. 21 " "
 4650 Set a post for the ca of sec. 11 & 14 on the Left Bank of
 White River from which,
 Sugar 8 in dia: bears N 54 W. 13 lbs dist; 70,
 Buck. 12 " " " N 76 E. 24 " "
 Lands rich and level.
-
- South Between Sec. 10 & 11. I. A. A. R. 277.
 40,00 Set a post for the ca of sec. 10 & 11 from which,
 N Ash 10 in dia: bears S 87 W. 14 lbs dist; 70,
 Buck 8 " " " North 26 " "
 6300 To a Rock 8 links N. Sec. 10.
 80,00 Set a post for the ca of sec. 10, 11, 14 & 15 from which,
 Buck 12 in dia: bears N 63 E. 3 lbs dist; 70,
 Lc. 18 " " " N 33 W. 11 " "
 Lands rich and timber same.
-
- West On a Random line between Sec. 2 & 11. I. A. A. R. 277.
 40,00 Set a temporary post.
 80,00 Intersect the N 73 line at the post ca of sec. 2, 3 & 11
 Lands the same, as last one. Rich & rolling Timber
 Buck, Poplar, Hackberry.
-
- East On the line between Sec. 2 & 11. I. A. A. R. 277.
 40,00 Set the temporary post at the ar dist on the line from
 which, Buck 10 in dia: bears N 55 W. 10 lbs dist;
 Lc. 10 " " " N 85 E 29 " "

80.00	To the post on of sec. 1, 2, 11 & 12.
South	Return Sec. 21 & 3. T. A. A. R. J. W.
40.00	Set a post from which, Back 10 in dist. bears N 22° W. 16 lbs. ash, m, N Walnut 8 " " " N 35° E 18 " "
80.00	Set a post for the cor of sec. 2, 3, 10 & 11 from which, Back 8 in dist. bears N 7° W. 12 lbs. ash, m, Do. 8 " " " N 7° E. 14 " "
North	Return Sec. 33 & 34. T. A. A. R. J. W.
12.50	To a spring branch 4 miles N. Course W.
40.00	Set a post from which, Back 6 in dist. bears S 7° W. 12 lbs. ash, m, N Oak 20 " " " East 12 " "
80.00	Set a post for the cor of sec. 27, 28, 33 & 34 from which, Back 10 in dist. bears N 40° E. 11 lbs. ash, m, Do. 10 " " " S 35° E. 31 " " Land very hilly; timber Buck, & Oak.
East	On a random line between Sec. 27 & 34 T. A. A. R. J. W.
20.00	To a spring Course N.
40.00	Set a post from which,
79.81	Intersect the N 7° S line 12 miles South of the post cor of Sec. 26, 27, 34 & 35. Land the same.
West	On the line between Sec. 27 & 34 T. A. A. R. J. W.
39.90	Set the timber post at the ar. ash on the line from which, Sugar 10 in dist. bears N 41° E. 23 lbs. ash, m, and a Do. 10 " " " S 35° E. 11 " "
79.81	To the cor of sec. 27, 28, 33 & 34
North	Return Sec. 27 & 28 T. A. A. R. J. W.

40.00	Set a post from which, Back 12 in dist. bears N 40° E. 21 lbs. ash, m, Back 10 " " " N 42° W. 8 " "
80.00	Set a post for the cor of sec. 21, 22, 27 & 28 from which, N Oak 20 in dist. bears N 44° W. 43 lbs. ash, m, Do. 15 " " " N 45° E. 49 " " Land the same.
East	On a random line between Sec. 22 & 27 T. A. A. R. J. W.
20.00	To a spring 10 miles N. Course A. E.
40.00	Set a timber post from which,
80.00	Intersect the N 7° S line 12 miles South of the post cor of sec. 22, 23, 26 & 27. Land the same.
West	On the line between Sec. 22 & 27 T. A. A. R. J. W.
40.00	To a sugar 12 in dist. stands at the ar. ash on the line from which, Sugar 10 in dist. bears N 40° E. 11 lbs. ash, m, Do. 10 " " " S 35° E. 31 " "
80.00	To the cor of sec. 21, 22, 27 & 28.
North	Return Sec. 20 & 23 T. A. A. R. J. W.
40.00	Set a post from which, Back 10 in dist. bears S 37° W. 38 lbs. ash, m, Do. 12 " " " S 28° W. 38 " "
41.51	To a spring Sec. 22 & 23.
80.00	Set a post for the cor of sec. 15, 16, 21 & 22 from which, Back 8 in dist. bears N 40° E. 33 lbs. ash, m, Do. 12 " " " S 35° W. 14 " " This line was very high hills & many rocks.
East	On a random line between Sec. 15 & 23 T. A. A. R. J. W.
40.00	Set a post from which,
79.13	Intersect the N 7° S line 81 miles South of the post cor of Sec. 14, 15, 22 & 23. Good land for farming.

T. N. 4. N. R. N. 3rd 2nd Mer. Ind.

West On the line between Sec. 15 & 22 T. 4. N. R. 2nd N.
39.567 Set the tempst 1/2 sec post at the cr. dist. in the true line
from which, Poplar. 39 in dia: beam S 88 E. 121 lbs dist
79.13 To the post on of sec 15. 16. 21 & 22.

North Return Sec 15 & 16 T. 4. N. R. 2nd N.
23.95 To a Poplar. 30 in dia: in the line.
40.00 Set a 1/2 sec post from which,
Dogwood 6 in dia: beam S 51 N 3 lbs dist; 12,
Beck. 6 " " " S 49 E. 7 " "
80.00 Set a post for the cr of sec 9. 10. 15 & 16 from which,
Sugar. 12 in dia: beam S 64 E. 11 lbs dist; 12,
Beck. 10 " " " S 29 N. 10 " "
Land the same.

East Return Sec 10 & 15 T. 4. N. R. 2nd N.
40.00 Set a 1/2 sec post from which,
Beck 10 in dia: beam N 89 N 31 lbs dist; 12,
No 9 " " " N 81 E. 4 " "
67.50 Set a post on the Left Bank of N. River for the cr
of sec 10 & 15 from which,
Sugar. 10 in dia: beam S 54 E. 7 lbs dist; 12,
Beck 12 " " " N 15 N. 20 " "
Land good for farming.

West Return Sec 10 & 15 T. 4. N. R. 2nd N.
37.1 Set the tempst post on the Right Bank of N. River for the
cr of sec 10 & 15 from which,
Beck 20 in dia: beam N 14 E. 16 lbs dist; 12,
No. 24 " " " S 55 E. 36 " "

North Return Sec 9 & 10 T. 4. N. R. 2nd N.
39.71 Set a post on the Left Bank of N. River for the cr of
sec 9 & 10 from which,

beamed

T. N. 4. N. R. N. 3rd 2nd Mer. Ind.

Sugar. 10 in dia: beam N 59 N. 10 lbs dist; 12,
No. 6 " " " S 37 E. 9 " "
South Return Sec 9 & 10 T. 4. N. R. 2nd N.
40.00 Set a 1/2 sec post on the Right Bank of N. River
for the cr of sec 9 & 10 from which,
ash 10 in dia: beam N 51 E. 17 lbs dist; 12,
N Oak 12 " " " North 26 " "
Land the same.

West On a Remains line between Sec 3 & 10 T. 4. N. R. 2nd N.
40.00 Set a tempst 1/2 sec post.
80.00 Enter sec the N 13 line 12 miles South of the post on of
Sec 3 & 14. 9 & 10. Land the same rich and rolling
Timber Poplar, Beech, Walnut, & Ash, &c.

East On the line between Sec 3 & 10 T. 4. N. R. 2nd N.
40.00 Set the 1/2 sec post. at the cr dist in the true line from
which, Sugar. 12 in dia: beam S 64 N. 24 lbs dist; 12,
Beck 20 " " " N 37 N. 11 " "
80.00 To the post on of sec 2, 3 & 10 & 11.

South Return Sec 3 & 14 T. 4. N. R. 2nd N.
40.00 Set a 1/2 sec post from which,
Sugar. 10 in dia: beam N 15 N. 13 lbs dist; 12,
No. 8 " " " N 45 E. 2 " "
37.00 To a Beck 18 miles north, corner N.
80.00 Set a post for the cr of sec 3 & 14. 9 & 10 from which,
Beck. 12 in dia: beam N 17 N 31 lbs dist; 12,
Immense 7 " " " S 77 N 9 " "
Land rolling & rich

North Return Sec 2 & 33 T. 4. N. R. 2nd N.
40.00 Set a 1/2 sec post from which,

22

80.00	13 Oak 12 in dia. beam A467. 10 lbs dist. 20, W Oak 24 " " A39 E. 16 " " Set a post for the car of sec. 28, 29, 32 & 33 from which Beck, 11 in dia. beam A25 E. 42 lbs dist. 20, Poplar, 9 " " A627. 18 " "
East 40.00	On a Random line between Sec. 28 & 33. T. A. A. R. 277. Set the tripot for the post.
80.39	Intersect the NTS line at the post on of sec. 27, 28, 32 & 33 Sound the same as last mile.
West 40.197	On the True line between Sec. 28 & 33. T. A. A. R. 277. Set the tripot for the post at the ar dist. on the true line from which, Beck 30 in dia. beam A422 E. 23 lbs dist. and co. Lc. 10 " " S30 E. 18 " "
80.39	Set the post on. of sec. 28, 29, 32 & 33
North 40.00	Return Sec. 28 & 29. T. A. A. R. 277. Set a post for the post from which, Beck, 16 in dia. beam. A15 E. 45 lbs dist. 20, W Oak 36 " " A477. 23 " "
78.00	Set a spring corner 77.
80.00	Set a post for the cor of sec. 20, 21, 28 & 29 from which, Beck, 8 in dia. beam. A377. 40 lbs dist. 20, Lc. 10 " " A73 E. 20 " "
East 40.00	On a Random line between Sec. 31 & 38. T. A. A. R. 277. Set a tripot for the post.
80.50	Intersect the NTS line at the post on of sec. 21, 22, 27 & 28 Sound very hilly
West 40.25	On the True line between Sec. 31 & 38. T. A. A. R. 277. Set the tripot for the post at the ar dist. on the true line

80.50	from which, Beck, 9 in dia. beam S22 E. 3 lbs dist. and co. W Oak 11 " " S87 E. 14 " " Set the cor of sec. 20, 21, 28 & 29.
North 40.00	Return Sec. 20 & 21. T. A. A. R. 277. Set a post for the post from which, Beck, 12 in dia. beam. A14 E. 50 lbs dist. 20, Hick 12 " " S32 E. 16 " "
80.00	Set a post for the cor of sec. 16, 17, 20 & 21. from which, W Oak 20 in dia. beam S217. 19 lbs dist. 20, Lc. 15 " " S617. 23 " " Sound rolling.
East 40.00	On a Random line between Sec. 16 & 21. T. A. A. R. 277. Set a tripot for the post.
80.00	Intersect the NTS line 45 miles South of the post on. of sec. 15, 16, 21 & 22. Sound hilly. Sound the same.
West 40.00	On the True line between Sec. 16 & 21. T. A. A. R. 277. Set the tripot for the post at the ar dist. on the true line from which, W Oak 10 in dia. beam S46 E. 28 lbs dist. 20, W Oak 20 " " S297. 34 " "
80.00	Set the cor of sec. 16, 17, 20 & 21
North 27.00	Between Sec. 16 & 17. T. A. A. R. 277. To a brook 10 lbs mid. corner. 77.
30.00	" " Lc. 10 " " 77.
40.00	Set a post for the post from which, W Walnut 12 in dia. beam. A08 E. 3 lbs dist. 20, Beck 10 " " A617. 33 " "
80.00	Set a post for the cor of sec. 8, 9, 16 & 17 from which, W Oak 20 in dia. beam S77. 58 lbs dist. 20, Logwood 6 " " S627. 5 " "

I. N. 4. N. R. N. 277. 2nd. Mm. S. d. 2.

Sands the same.

East On a Random line between Sur 9716 I. N. R. 277.
40.00 Set a trap for 20 feet
79.00 Set a trap on the N. B. line at the foot of row 9. 10. 15716
Sands the same.

West On the same line between Sur 9716 I. N. R. 277.
39.50 Set the trap for 20 feet at the arch on the line
from which, Sugar. 12 in dia. beam. N 81 E. 7 lbs ash, 20,
and a Buck 8 " " " 6387 22 " "
79.00 Set the end of row 9. 8. 10. 117.

North Return Sur 849 I. N. R. 277.
40.00 Set a trap for 20 feet from which,
Buck 10 in dia. beam. N 87 W. 35 lbs ash, 20,
No. 8 " " " N 15 W. 31 " "
61.00 Set a trap on the Left Bank of White River for the co.
of Frae. Sur 849 from which,
Sugar. 8 in dia. beam. N 26 E. 5 lbs ash, 20,
No. 8 " " " N 16 W. 20 " "
Sands rich, timber Buck, Oak, Hick. &c.

South Return Sur 849 I. N. R. 277.
5.11 To a Buck 10 in dia. in the line.
20.00 Set a trap on the Right Bank of W. River for the co.
of Frae. Sur 849 from which,
Sugar. 10 in dia. beam. N 19 W. 14 lbs ash, 20,
Buck. 10 " " " N 15 W. 20 " "
Sands rich.

East Return Sur 449 I. N. R. 277.
11.26 Set a trap for the end of Frae. Sur 449 on the
Right Bank of W. River from which.

I. N. 4. N. R. N. 277. 2nd. Mm. S. d. 2.

Sugar. 12 in dia. beam. N 88 W. 30 lbs ash, 20,
Buck. 8 " " " 6387 22 " "

West Return Sur 449 I. N. R. 277.
23.20 To a Buck. 18 lbs in dia. beam. &c.

40.00 Set a trap for 20 feet from which,
Buck 10 in dia. beam. N 29 W. 10 lbs ash, 20,
No. 12 " " " N 4 E. 20 " "

46.79 Set a trap on the Right Bank of White River for the
co. of Frae. Sur 449 from which,
Sugar. 10 in dia. beam. N 38 W. 13 lbs ash, 20,
No. 10 " " " 6327 7 " "
Sands the same.

South Return Sur 449 I. N. R. 277.
40.00 Set a trap for 20 feet from which,
Buck 10 in dia. beam. N 5 W. 33 lbs ash, 20,
No. 6 " " " N 30 E. 19 " "
80.00 Set a trap for the end of row 4. 5. 8 & 9 from which,
Buck 10 in dia. beam. N 59 W. 19 lbs ash, 20,
Sugar. 12 " " " N 19 W. 17 " "
Sands rich and rolling.

North Return Sur 31132 I. N. R. 277.
9.00 To a Sugar. 14 in dia. in the line.
20.90 Set a trap on the same line for the end of Frae. Sur 31132
from which an Immor 5 in dia. beam. N 49 E. 10 lbs ash
and a Sugar. 20 in dia. beam. N 46 E. 5 lbs ash, 20,
Sands flat ridge 2nd. rate, Oak, some Sugar, Hack-
berry, W. Walnut, &c.

North Return Sur 31132 I. N. R. 277.
32.00 To a Buck. 10 lbs in dia. beam, No. 2 W.
34.10 " " " " 24 in dia. in the line.
40.00 Set a trap for 20 feet from which.

T. A. H. R. A. D. M. S. Ind.

- 67.80 To a Brook 20 in dist. from S. E. 16th dist. to
Reck 12 " " " A 43 N 10 " "
- 80.00 Set apart from the ca of sw 29.30.31 132 from which,
Nick 10 in dist. from S. E. 15th dist. to
Sugar 12 " " " S 6 N 32 " "
Con very hilly land.
-
- East Oak Random line between Sec 29 132 T. 4. N. R. 27 N
40.00 Set a trip. to sw post
80.95 Later set the NW line 20 links North of the post
cor of sw 28.29.32 133 Land the same.
-
- West On the line between Sec 29 132 T. 4. N. R. 27 N
40.45 Set the trip. to sw post at the ar dist on the line
from which, Dogwood 6 in dist. from S. E. 12th dist.
and a Poplar. 30 " " " S 43 N 9 " "
80.95 To the ca of sw 29.30.31 132
-
- West Between Sec 31 131 T. 4. N. R. 27 N.
6.25 To a Spring corner N.
40.00 Set a post from which,
Dogwood 6 in dist. from S. E. 10th dist. to
Poplar. 20 " " " S 54 N 14 " "
80.17 Later set the West corner and set apart for
the ca of sw 30 131. 1 1/2 the North of the post
" " " 25 136 T. 4. N. R. 3 N from which
Reck 12 in dist. from S. E. 13th dist. to
Re. 20 " " " S 62 N 32 " "
-
- North Between Sec 29 130 T. 4. N. R. 27 N.
11.50 To a Spring corner N.
40.00 Set a post from which,

T. A. H. R. A. D. M. S. Ind.

- 61.25 To a Brook 20 in dist. from S. E. 17th dist. to
Reck. 8 " " " S 22 E 36 " "
- 80.00 Set apart from the ca of sw 19.20.29 130 from which,
Sugar 10 in dist. from S. E. 37th dist. to
Re. 20 " " " S 19 N 8 " "
Land the same.
-
- East Oak Random line between Sec 20 129 T. 4. N. R. 27 N
40.00 Set a trip. to sw post
78.00 To a Brook 20 links mid. corner N. N.
81.00 Later set the NW line 30 links North of the post
cor of sw 20.21.28 129 Land the same.
-
- West On the line between Sec 20 129 T. 4. N. R. 27 N
40.50 Set the trip. to sw post at the ar dist on the line
from which, Hick 18 in dist. from S. E. 25th dist.
and a Re. 8 " " " S 12 E 28 " "
81.00 To the ca of sw 19.20.29 130
-
- West Between Sec 19 130 T. 4. N. R. 27 N.
22.25 To a Brook 20 links mid. corner N. N.
40.00 Set a post from which,
Sugar 15 in dist. from S. E. 23th dist. to
Hick 12 " " " S 21 N 23 " "
49.00 Set apart on the Sept Point of N River for the
cor of tract Sec 19 130 from which,
Sugar 10 in dist. from S. E. 32th dist. to
Dogwood 6 " " " S 8 E 28 " "
Land very hilly. Land the same.
-
- East Between Sec 19 130 T. 4. N. R. 27 N

T. N. 4. N. R. N. 27. 2nd Mer. Ind.

25.30 Set a post on the Right Bank of White River for
the cor of frac^d Sur 19530 from which,
Beck. 8 in dia^r beam. A 25 M 16 lbs cast, 10,
No. 8 1/2 " " 160 N. 19 " "
Land level & rich Timber Buck, Sugar, & ash.

North Return Sur 19520 T. 4. N. R. 27.

40.00 Set a post from which,
Beck. 15 in dia^r beam. A 40 E. 13 lbs cast, 10,
No. 15 " " " 142 N. 18 " "

80.00 Set a post for the cor of sec 17, 18, 19 & 20 from which,
Sugar. 19 in dia^r beam. S 51 E. 5 lbs cast, 10,
Beck. 10 " " " 161 N. 16 " "
This mile run very high hills and rocks

East On a Random line between Sur 17 & 20 T. 4. N. R. 27.
40.00 Set a tripit for 20 post.
81.86 Set out the N 13 line at the post cor of sec 16.
17, 20 & 21. Land good; mainly Spruce Timber same

West On the True line between Sur 17 & 20 T. 4. N. R. 27.
40.93 Set the tripit for 20 post at the cor. ash on the true line
from which, Beck. 20 in dia^r beam. S 87 N. 5 lbs cast
under a Hogwood 5 " " " 185 E. 9 " "
81.96 Set the cor of sec 17, 18, 19 & 20

West Return Sur 18419 T. 4. N. R. 27.
33.75 To a Poplar 29 in dia^r in the.
40.00 Set a post from which,
Beck. 20 in dia^r beam. S 89 E. 23 lbs cast, 10,
No. 10 " " " 143 N. 5 " "
63.00 Set a post on Left Bank of W. River for the cor
of frac^d Sur 18419 from which,

T. N. 4. N. R. N. 27. 2nd Mer. Ind.

Elm. 10 in dia^r beam. A 55 E. 7 lbs cast, 10,
Synn. 6 " " " 165 N. 7 " "
Land the same.

East. Return Sur 18419 T. 4. N. R. 27.

8.00 To a Hackberry 12 in dia^r stands for the cor of frac^d
Sur 18419 on the Right Bank of W. River.

North Return Sur 17 & 18 T. 4. N. R. 27.

11.50 To a Birch 8 limbs in dia^r, corner N.

40.00 Set a post from which,
Beck. 10 in dia^r beam. A 66 E. 17 lbs cast, 10,
Sugar. 8 " " " 128 E. 10 " "

55.50 To a Birch 15 limbs in dia^r, corner N.

80.00 Set a post for the cor of sec 7, 8, 17 & 18 from which,
Beck. 20 in dia^r beam. S 82 N. 19 lbs cast, 10,
No. 20 " " " 182 E. 24 " "
Land good for farming; Timber Buck, Oak,
Poplar.

East On a Random line between Sur 8 & 11 T. 4. N. R. 27.

40.00 Set a tripit for 20 post.

80.00 Set out the N 13 line 20 limbs South of the post cor
of sec 8, 9, 16 & 17. Land the same.

West On the True line between Sur 8 & 11 T. 4. N. R. 27.

40.00 Set the tripit for 20 post at the cor. ash on the true line
from which, W. Oak. 13 in dia^r beam. A 49 E. 4 lbs cast
under a No. 12 " " " 179 N. 16 " "

80.00 Set the post cor of sec 8, 9, 17 & 18.

West Return Sur 7 & 18 T. 4. N. R. N. 27.

9.00 To a Large Spring corner d.

37.75 To a Birch 20 in dia^r in the line.

T. N. 4. N. R. N. 272nd Min. Sud.

40.00 Set a 1/2 sec post from which,
Beck 12 in dia^r bears N 79 E. 32 lks dist. to
Hackberry 12 1/2 " " S 62 W. 13 " "
51.33 Set a post on the Left Bank of White River for the
Cor of Grad. Sec 7 118 from which,
Sugar 12 in dia^r bears S 46 W 7 lks dist; to,
Co. 12 1/2 " " N 48 E. 22 1/2 "
Sand good Timber Beck, Ash, Sugar, &
Hackberry &c.

East Return Sec 7 118 T. 4. N. R. 272.
21.17 To an Ironwood 10 in dia^r stands for the cor of
Grad. Sec 7 118 on the Right Bank of White River
Lands hilly

North Return Sec 7 118 T. 4. N. R. 272.
40.00 Set a 1/2 sec post from which,
Beck 12 in dia^r bears N 44 E. 15 lks dist; to,
Co. 8 " " S 37 W. 8 " "
48.00 Set a post on the Left Bank of White River for the
cor of Grad. Sec 7 118 from which,
Sugar 12 in dia^r bears S 4 E. 60 lks dist; to,
Sugar 15 " " S 45 W 37 " "
Land the same.

South Return Sec 7 118 T. 4. N. R. N. 272.
13.00 To a Rock 8 links under corner W.
31.30 Set a post on the Right Bank of White River
for the cor of Grad. Sec 7 118 from which,
Beck 12 in dia^r bears North 12 links dist; to,
Co. 10 " " S 36 E. 17 " "

West On a Random line between Sec 5 & 8 T. 4. N. R. 272
40.00 Set a tripit for sec post

T. N. 4. North of R. N. 272nd Min. Sud.

65.00 To a Rock 10 links under Corner S.
80.00 Set a post on the N 43 line 10 links North of the post cor
of Sec 5, 6, 7, & 8. Land the same.

East On a line between Sec 5 & 8. T. 4. N. R. 272.
40.00 Set a tripit for sec post at the cor dist on the line
from which, Beck 8 in dia^r bears S 40 W 14 lks dist
under a Rock 7 " " S 31 E. 17 " "
80.00 To the post cor of sec 4, 5, 8 & 9

West Return Sec 6 & 7 T. 4. N. R. 272.
40.00 Set a 1/2 sec post from which,
Sugar 10 in dia^r bears N 56 W. 2 lks dist; to,
Co. 8 " " S 9 E. 13 " "
75.50 Set a post 540 links North of the post cor of sec.
1 & 2 T. 4. N. R. 372 for the cor of sec. 6 & 7
from which, Beck 8 in dia^r bears S 46 W 12 lks dist
under a Co. 18 " " S 17 E. 26 " "
Land the same.

South Return Sec 5 & 6 T. 4. N. R. 272.
40.00 Set a 1/2 sec post from which,
Sugar 9 in dia^r bears N 69 E. 4 lks dist; to,
Oak 10 " " S 17 E. 16 " "
80.00 Set a post for the cor of sec 5, 6, 7 & 8 from which
a Beck 12 in dia^r bears N 49 E. 13 lks dist
to Co. 10 " " S 66 E. 13 " "
Land hilly Timber Beck, Poplar, Ash, Oak,
Hackberry &c.

Meanders of the East Fork of White River from
the post in the West Boundary of T. 4. N. R. 272
thence up stream on the Right Bank

T. N. 4. A. R. N. 27. 2nd Mm. Ind.

A70 E 4.00 In sec. 30 T. 4. N. R. 27.
 A64 E 7.00
 A50 E 7.50
 A35 E 5.47 To the line between Sec. 19 & 30

A16 E 6.50 In sec. 19 T. 4. N. R. 27.
 A13 W 5.00
 A39 W 16.75
 A40 W 14.50
 A47 W 5.50
 A46 W 10.55 To post on Range line

From post on Range line West side of sec. 19
 North side of Bend.

A60 E 25.50
 A55 E 16.75
 A87 E 10.00
 A81 E 5.75
 A49 E 7.50
 A29 E 10.50
 A15 W 5.00
 A44 W 30.00 In sec. 18.
 A36 W 8.00 A Spring.
 A36 W 13.50
 A40 W 9.50
 A39 W 5.00 To line between Sec. 7 & 18.

A31 W 9.50 A Spring: in sec. 7 T. 4. N. R. 27.
 A16 W 8.50
 A12 W 6.75
 A16 W 22.00
 A22 E 10.00
 A34 E 19.50

T. N. 4. A. R. N. 27. 2nd Mm. Ind.

A55 E 13.60
 A77 E 6.50
 A60 E 10.50
 A57 E 9.50
 A61 E 6.50 To a Rock 5 links N.W.
 A61 E 6.00
 A57 E 10.60 To line between Sec. 7 & 8. I

A60 E 19.00 In sec. 8 T. 4. N. R. 27.
 A71 E 19.00
 A87 E 25.00
 A48 E 8.00
 A30 E 28.00
 A45 E 4.39 To line between Sec. 8 & 9.

A25 E 7.00 In sec. 9 T. 4. N. R. 27.
 A28 E 16.50 To the line between Sec. 4 & 9.

A28 E 3.80 In sec. 4 T. 4. N. R. 27.
 A49 E 9.00
 A60 E 12.50
 A39 E 4.62 To the line between Sec. 4 & 9.

A34 E 19.00 In sec. 9 T. 4. N. R. 27.
 A24 E 12.70
 A35 E 6.00 To a Rock 30 links N.W.
 A35 E 4.00
 A45 E 5.00
 A75 E 8.00
 A88 E 14.20 To the line between Sec. 9 & 10.

A86 E 17.50 In sec. 10 T. 4. N. R. 27.
 A86 E 14.00

T. N. 4. A. R. N. 27. 2nd. Mm. Ind.

A70 E. 4.00 In sec. 30 T. 4. N. R. 27.
 A64 E. 7.00
 A50 E. 7.50
 A35 E. 5.47 To the line between Sec. 19 & 30

A16 E. 6.50 In sec. 19 T. 4. N. R. 27.
 A13 W. 5.00
 A39 W. 16.75
 A40 W. 14.50
 A47 W. 5.50
 A46 W. 10.55 To post on Range line

From post on Range line West side of sec. 19
 North side of Bend.

A60 E. 25.50
 A55 E. 16.75
 A87 E. 10.00
 A81 E. 5.75
 A49 E. 7.50
 A29 E. 10.50
 A15 W. 5.00
 A44 W. 30.00 In sec. 18.
 A36 W. 8.00 Spring.
 A36 W. 13.50
 A40 W. 9.50
 A39 W. 5.00 To line between Sec. 18 & 19.

A31 W. 9.50 Spring? in sec. 7 T. 4. N. R. 27.
 A16 W. 8.50
 A12 W. 6.75
 A16 W. 22.00
 A22 E. 10.00
 A34 E. 19.50

T. N. 4. A. R. N. 27. 2nd. Mm. Ind.

A58 E. 13.60
 A77 E. 6.50
 A60 E. 10.50
 A57 E. 9.50
 A61 E. 6.50 To a Rock 5 links wide.
 A61 E. 6.00
 A57 E. 10.60 To line between Sec. 7 & 8. I

A60 E. 19.00 In sec. 8 T. 4. N. R. 27.
 A71 E. 19.00
 A87 E. 25.00
 A48 E. 8.00
 A30 E. 28.00
 A45 E. 4.39 To line between Sec. 8 & 9.

A25 E. 7.00 In sec. 9 T. 4. N. R. 27.
 A28 E. 16.50 To the line between Sec. 4 & 9.

A28 E. 3.80 In sec. 4 T. 4. N. R. 27.
 A49 E. 9.00
 A60 E. 12.50
 A39 E. 4.62 To the line between Sec. 4 & 9.

A34 E. 19.00 In sec. 9 T. 4. N. R. 27.
 A24 E. 12.70
 A35 E. 6.00 To a Rock 30 links wide.
 A35 E. 4.00
 A45 E. 5.00
 A35 E. 8.00
 A88 E. 14.20 To the line between Sec. 9 & 10.

A86 E. 17.50 In sec. 10 T. 4. N. R. 27.
 A86 E. 14.00

A577 9.24

A4077 7.50

A1177 13.50 To a Brook 10 links wide,

A4077 11.00

A3677 9.50

A4377 13.00

A3477 5.00 To the line between Sec. 7 & 18

A3477 8.50 In Sec. 7

A2177 13.00

A1377 21.00

A2177 15.50

A3877 10.00

A5377 8.50

A8277 3.00

S6577 9.50

S3677 14.50

S6577 11.50

S6177 16.50 To the cor of sec. 7 & 18

S6577 20.00

S7677 14.50

S8577 9.50

East 17.00

A4577 9.50

A2977 14.50

A3377 9.50 To the cor of Sec. 8 & 9. T. A. A. R. 277

A3377 31.50 In Sec. 9

S6777 4.00

S3877 21.50

S3077 22.00

S4977 16.50

S8977 17.50

A8677 4.50 To the cor of sec. 9 & 10.

A8677 4.50

S8877 30.00

A8677 14.50

In sec. 10.

S7477 10.50

S3777 5.00

S1177 6.00

S6777 16.00

S1577 11.50 To the cor of sec. 10 & 15.

A7777 5.00

S1277 15.00

In sec. 15.

S2077 9.00

S2477 4.50

S2477 5.00 To the cor of sec. 14 & 15.

S3277 15.50

S5477 26.80

A7277 22.00 To a Spring.

A5477 9.00 To the mouth of a Brook 12 links wide.

A2577 5.44

A1677 8.00

In sec. 14.

A2677 14.00

A2577 6.75

A3577 8.00

A3277 19.50 To the line between Sec. 11 & 14

From the cor. of the Range line East Boundary of
Sec. 1. T. A. A. R. 277. thence down stream in sec. 1

S4477 9.50

A7177 13.00

T. 4 N. R. 2 W. S. Mer. Ind. a.

S 76 W 12.50 In sec. 1.

S 53 W 18.00

S 26 W 15.00

S 5 W 10.50

S 5 E 9.00

S 13 E 7.50

S 17 E 15.00

S 77 E 5.72 To the cor of sec 1 & 12

S 77 E 5.50

S 10 E 34.00

In sec. 12.

S 5 W 14.00

S 69 W 11.50

S 88 W 15.50 To the cor of sec 11 & 12

S 88 W 16.00 In sec. 11

S 80 W 37.50

S 5 E 3.00

S 16 E 7.73

S 22 E 7.00

S 54 E 3.00 To the cor of sec 11 & 14.

The part in } Surveyed by
 Harrison's Purchase } Arthur Henric.
 Depy Sur.

The part South of } Surveyed by
 Harrison's Purchase } Tupper & Stone L.S.

T. 4 N. R. 2 W. S. Mer. Ind. a.

South Boundary

Beginning at cor. of sec. 31 & 32, T. 4 N. R. 2 W.

a Butternut 8 in. dia. bears S 82 E 5 1/2 in. dist. 3

a Do 7 1/2 " " N 82 W 5 1/2 " "

East on the S. Boundary of Sec. 32

40.00 a Beech 11 in. dia. marked for g. sec. cor.

64.00 Intersect the Indian Boundary line, set post from
 which a Beech 10 in. dia. bears S 60 E 19 in. dist. 3

a Sugar 16 " " N 60 W 23 " "

standing on Freeman's line

Hilly, Drate land, timber Oak some Beech

West on the S. Boundary of Sec. 31

40.00 a Beech 8 in. dia. marked for g. sec. cor.

80.39 to post cor. of T. 3 & 4 N. R. 2 & 3 W.

Land, timber &c. same as on the last mile

Surveyed by Tupper & Stone

Dec. 14. 1844 Dep. Surveyors

Comp.